

3,000-7,000 lb Capacity
Pneumatic Tire Forklift Trucks







Fiercely Flexible:

The cornerstone of any fleet, the FG25N works well outside or on mixed surfaces. First-rate maneuverability and top-notch lift and lowering speeds make it a breeze for operators to get the job done right.

The Rugged Hauler

The FG25N is the key player on any team. Don't let the cushy interior fool you — underneath it all, this truck is ready to work. Now, go lift something heavy.

The background of the advertisement is a photograph of the interior of a truck cab. It shows the steering wheel, the dashboard with a digital display, and various controls. The image is partially obscured by red text boxes and a white circular graphic.

Digital display: The information you need to keep your truck running efficiently — all in your line of sight.

Memory tilt steering: No need to readjust, the FG25N has it covered.

Three-point entry: Getting in and getting out is a snap. An open step, convenient grab bar and seat hip restraint offer three secure points for easy entry and exit.

Power Has A Softer Side

Built tough, this truck also has a softer side – from truly comfortable seats to memory tilt steering. Everything to keep your operators happy and efficient.



A few options to consider:

- **Swing-down LP tank** – our patented design makes changing LP tanks a breeze.
- **Full-suspension seat** – provides a soft ride for those long days.
- **Foot directional control** – give your hands a break and let your feet take you where you need to go.
- **Steering wheel knob** – making turns with one hand has never been easier.

So Reliable, You May Take It For Granted

Reliability comes standard on all Mitsubishi forklift trucks, but that's not all. These features will help keep your truck on the go, shift after shift.

EnviroO₂ Engines®:

High performance plus low CARB and EPA emissions... now that's a dynamic duo.





Drive-by-wire throttle control: Enhanced fuel efficiency, reduced emissions and responsive acceleration. Can you say “value”?

Full floating powertrain: Reduces wear and tear due to vibration. Pure heaven.

A few options to consider:

- **Debris resistance package** – a great choice, which includes underbelly and radiator screens, to protect the engine and transmission in applications with loose debris.
- **Fuel-saver mode** – by controlling acceleration, this option can reduce fuel consumption and improve tire life.
- **Air intake pre-cleaner** – this option filters the pollutants and debris in air and keeps them from entering the engine.
- **Service indicator package** – keep your truck in motion with a radiator coolant level warning light and an air cleaner service indicator.

Integrated Presence System (IPS):

Helps manage risk by temporarily disengaging the drive and hydraulic functions if operators leave the normal operating position.

Enhanced visibility: The more you see, the better, right? Narrow mast channels, a low-profile counterweight and two forward work lights help expand your horizons.

Serious About Safety

There'll be no puns here. Each Mitsubishi forklift truck is designed with safety features that help maximize the well-being of your operators. Period.





A few options to consider:

- **Ground speed control** – gives you the ability to set and enforce speed limits on your forklift fleet.
- **Orange seat belt** – provides a quick visual indicator of whether your operators are wearing their seat belts.
- **Light, strobe and alarm packages** – choose a package that enhances the visibility and awareness of the forklift in your application.

Green: it just grows on you.



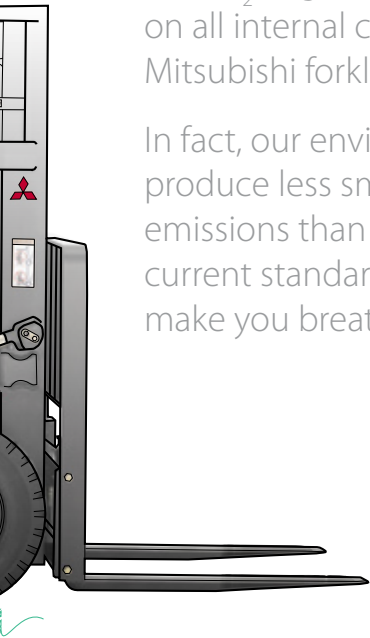

When we think about your environment, we also think about THE environment.

Did you know that our enviro₂ engines® are standard on all internal combustion Mitsubishi forklift trucks?

In fact, our enviro₂ engines produce less smog-forming emissions than allowed by the current standards. Doesn't that make you breathe a little easier?

Mitsubishi Heavy Industries is on the leading edge of green technology:



Wind turbines



CO₂ recovery



Public transportation



ISO 14001 manufacturing facilities

The Small And Medium

CHARACTERISTICS					FG15N		FG18N	
1								
2	Capacity	at rated load center	lb	kg	3,000 / 1,500		3,500 / 1,750	
3		at load center – distance	in	mm				
4	Power	electric, diesel, gasoline, LP gas						
5	Tire type	cushion, pneumatic						
Dimensions								
6	Lift with standard two-stage mast	maximum fork height	in	mm	130 / 3,300			
7		free fork height	in	mm	4.5 / 115			
8	Forks	thickness x length x width	in	mm	1.4 X 4 X 42 / 35 x 100 x 1,070			
9	Fork spacing	out-to-out minimum / maximum	in	mm	7.9/36.2 /			
10	Tilt	forward / backward	deg					
11	Overall Dimensions	length to fork face	in	mm	89.0 / 2,260	90.6 / 2,300		
12		width	with standard tires	in	mm	42.0 / 1,070		
13			w/ optional dual tires	in	mm	N/A		
14		height	with lowered mast	in	mm			
15			seat height	in	mm	42.6 / 1,080		
16			to top of overhead guard	in	mm	81.3 / 2,065		
17	with extended mast		in	mm				
18	Minimum outside turning radius			in	mm	76.8 / 1,950	78.0 / 1,980	
19	Minimum aisle – 90° stack – zero clearance w/o load			in	mm	92.5 / 2,350	93.7 / 2,380	
Performance								
20	Speeds	travel loaded / empty	mph	km/h				
21		lift speed loaded / empty	fpm	mm/s	124/128 / 630/			
22		lowering speed loaded / empty	fpm	mm/s	102/98 / 520/			
23	Gradeability	loaded at 1 mph (1.6 km)	%		47.4	41.7		
24		maximum loaded / empty	%		38.8 / 18.2	38.5 / 15.9		
Weight								
25	Empty		lb	kg	5,650 / 2,560	6,070 / 2,750		
26	Axle load	with rated load front / rear	lb	kg	7,900/960 / 3,580/440	8,700/1,140 / 3,950/		
27		without load front / rear	lb	kg	2,430/3,075 / 1,100/1,390	2,330/3,625 / 1,060/		
Chassis								
28	Ground clearance	at lowest point of mast	in	mm	4.3 / 110			
29		at center of wheel base	in	mm	6.0 / 152			
30	Brakes	service						
31		parking						
Powertrain								
32	Engine	model						
33		continuous output (S.A.E. gross)		HP	kW			
34				at r.p.m.				
35		maximum torque (S.A.E. gross)		lb-ft	Nm			
36				at r.p.m.				
37		cylinder displacement	cu in	L				
38	Transmission	type						
39		number of speeds forward / reverse						
40	Relief pressure	for attachments at main	psi	bar				

NOTE: These specifications assume the use of drive axles, tires and tilt angles specified. Any modification to specifications, or any other combination of specifications made after the shipment of the truck, requires prior written approval from Mitsubishi Caterpillar Forklift America Inc. ("MCFA"). (See ANSI/ITSDF B56.1.)

FG20CN		FG20N		FD20N	FG25N	FD25N	
		4,000 / 2,000			5,000 / 2,500		
		24 / 500					
gasoline / LP gas				diesel	gasoline / LP gas	diesel	
		pneumatic					
		131 / 3,330					
4.7 / 120		5.5 / 140			5.7 / 140		
		1.6 x 4 x 42 / 40 X 100 X 1,070					
200/920		8.7/39.4 / 220/1,000					
		6° / 10°					
92.7 / 2,355		97.8 / 2,485			100.8 / 2,560		
		45.5 / 1,160					
		64.5 / 1,640					
		84.5 / 2,150					
		42.6 / 1,080			43.0 / 1,090		
		81.7 / 2,074					
		180 / 4,570					
79.5 / 2,020		86.5 / 2,200			87.8 / 2,230		
95.8 / 2,435		104.4 / 2,654			105.9 / 2,689		
		11.8/12.1 / 19.0/19.5					
650		114/116 / 580/590	124/130 / 630/660	114/116 / 580/590	124/130 / 630/660		
500		98/98 / 500/500					
	35.1	33.6	35.6	28.7	30.2		
	38.0 / 14.3	39.1 / 18.5	40.4 / 18.7	39.8 / 16.5	40.0 / 16.4		
	6,710 / 3,040	7,370 / 3,340	7,610 / 3,450	7,990 / 3,620	8,210 / 3,720		
520	9,600/1,410 / 4,350/640	10,200/1,450 / 4,630/660	10,300/1,590 / 4,670/720	12,000/1,470 / 5,440/670	12,100/1,620 / 5,490/730		
1,640	2,350/4,275 / 1,070/1,940	3,200/4,075 / 1,450/1,850	3,300/4,225 / 1,500/1,920	3,175/4,775 / 1,440/2,170	3,250/4,925 / 1,470/2,230		
		4.6 / 117					
		6.6 / 167					
		foot-operated, hydraulic					
		hand-operated, mechanical					
K21		S4S		K21		S4S	
50.3 / 37.5		51.1 / 38.1		50.3 / 37.5		51.1 / 38.1	
2,700		2,250		2,700		2,250	
111 / 151		136.4 / 185		111 / 151		136.4 / 185	
1,800		1,700		1,800		1,700	
126 / 2.1		203 / 3.3		126 / 2.1		203 / 3.3	
		powershift					
		1 / 1					
		2,625 / 181					

Also be advised that overall operating visibility may be affected by the mast configuration and mast options of your forklift truck. Therefore, you may need to add ancillary [auxiliary] devices or modify your operating practices. Consult your dealer for further information.

The Big And Burly

CHARACTERISTICS				
1			lb	kg
2	Capacity	at rated load center		
3		at load center – distance		in mm
4	Power	electric, diesel, gasoline, LP gas		
5	Tire type	cushion, pneumatic		
Dimensions				
6	Lift with standard two-stage mast	maximum fork height		in mm
7		free fork height		in mm
8	Forks	thickness x length x width		in mm
9	Fork spacing	out-to-out minimum / maximum		in mm
10	Tilt	forward / backward		deg
11	Overall Dimensions	length to fork face		in mm
12		width	with standard tires	in mm
13			w/ optional dual tires	in mm
14		height	with lowered mast	in mm
15			seat height	in mm
16			to top of overhead guard	in mm
17	with extended mast		in mm	
18	Minimum outside turning radius			in mm
19	Minimum aisle – 90° stack – zero clearance w/o load			in mm
Performance				
20	Speeds	travel loaded / empty		mph km/h
21		lift speed loaded / empty		fpm mm/s
22		lowering speed loaded / empty		fpm mm/s
23	Gradeability	loaded at 1 mph (1.6 km)		%
24		maximum loaded / empty		%
Weight				
25	Empty			lb kg
26	Axle load	with rated load front / rear		lb kg
27		without load front / rear		lb kg
Chassis				
28	Ground clearance	at lowest point of mast		in mm
29		at center of wheel base		in mm
30	Brakes	service		
31		parking		
Powertrain				
32	Engine	model		
33		continuous output (S.A.E. gross)		HP kW
34				at r.p.m.
35		maximum torque (S.A.E. gross)		lb-ft Nm
36				at r.p.m.
37		cylinder displacement	cu in L	
38	Transmission	type		
39		number of speeds forward / reverse		
40	Relief pressure	for attachments at main		psi bar

FG30N	FD30N
6,000 / 3,000	
gasoline / LP gas	diesel
130 / 3,300	
1.8 x 5 x 42 / 45 X 125 X 1,070	
107.7 / 2,735	
82.4 / 2,093	
179 / 4,550	
93.7 / 2,380	
113.2 / 2,875	
11.8/12.1 / 19.0/19.5	
100/104 / 510/530	98/104 /
104/118 / 530/600	104/98 /
26.4	24.5
40.3 / 17.1	41.1 /
9,400 / 4,260	
9,640 /	
14,300/1,670 / 6,490/760	14,400/1,810 /
3,825/5,500 / 1,730/2,490	3,900/5,700 /
5.4 / 136	
7.4 / 189	
K25	
S4S	
58.7 / 43.8	
51.1 /	
2,700	
2,250	
137.2 / 186	
136.4 /	
1,600	
1,700	
152 / 2.5	
203 /	

NOTE: These specifications assume the use of drive axles, tires and tilt angles specified. Any modification to specifications, or any other combination of specifications made after the shipment of the truck, requires prior written approval from Mitsubishi Caterpillar Forklift America Inc. ("MCFA"). (See ANSI/ITSDF B56.1.)

	FG33N	FD33N	FG35N	FD35N				
	6,500 / 3,250		7,000 / 3,500					
	24 / 500							
	gasoline / LP gas	diesel	gasoline / LP gas	diesel				
	pneumatic							
	131 / 3,330							
	5.9 / 150							
	2.0 x 5 x 42 / 50 X 125 X 1,070							
	9.8/39.4 / 250/1,000							
	6° / 10°							
	108 / 2,740		110.0 / 2,795					
50.0 / 1,270			51.0 / 1,300					
	67.5 / 1,710							
85.5 / 2,170			91.0 / 2,310					
	44.9 / 1,140							
	84.0 / 2,130		82.8 / 2,103					
			180 / 4,570					
			96.0 / 2,440					
	115.3 / 2,930		115.5 / 2,935					
					11/11.5 / 17.7/18.5		10.5/11.5 / 16.9/18.5	
500/530					99/100 / 503/508		96/100 / 488/508	
530/500					98/98 / 500/500		85/86.6 / 430/440	
					19.1		83/78.7 / 420/400	
					20.6		21.9	
17.3	40.9 / 14.8		20.6					
	40.6 / 14.9		39.7 / 14.6					
	40.6 / 14.9							
4,370	10,150 / 4,600	10,390 / 4,710	10,340 / 4,690	10,590 / 4,800				
6,530/820	15,100/2,130 / 6,850/970	15,200/2,270 / 6,890/1,030	15,900/2,060 / 7,210/930	16,000/2,200 / 7,260/1,000				
1,770/2,590	3,750/6,300 / 1,700/2,860	3,825/6,400 / 1,730/2,900	3,675/6,600 / 1,670/2,990	3,775/6,700 / 1,710/3,040				
	5.4 / 140		5.4 / 146					
			7.0 / 180					
	foot-operated, hydraulic							
	hand-operated, mechanical							
	K25	S4S	K25	S4S				
38.1	63.0 / 47.0	59.0 / 44.1	58.7 / 43.8	51.1 / 38.1				
	2,700	2,300	2,700	2,250				
185	139 / 188	135 / 183	137.2 / 186	136.4 / 185				
	1,600	1,800	1,600	1,700				
3.3	152 / 2.5	203 / 3.3	152 / 2.5	203 / 3.3				
	powershift							
	1 / 1							
	2,625 / 181							

Also be advised that overall operating visibility may be affected by the mast configuration and mast options of your forklift truck. Therefore, you may need to add ancillary [auxiliary] devices or modify your operating practices. Consult your dealer for further information.

Safety Standards

These trucks meet American National Standards Institute/ Industrial Truck Standards Development Foundation, ANSI/ITSDF B56.1. UL-Classified by Underwriters Laboratories, Inc., as to fire and electric shock hazard only; Type G, G/LP, LP, D (standard). Type GS, LPS and DS (optional). Users should be aware of, and adhere to, applicable codes and regulations regarding operator training, use, operation and maintenance of powered industrial trucks, including:

- ANSI/ITSDF B56.1.
- NFPA 505, fire safety standard for powered industrial trucks, including type designations, areas of use, maintenance and operation.
- Occupational Safety and Health Administration (OSHA) regulations that may apply.

Specifications, equipment, technical data, photos and illustrations based on information at time of printing and subject to change without notice. Some products may be shown with optional equipment.

Call-out numbers shown in the diagram to the right correspond to the first column of the specifications chart.

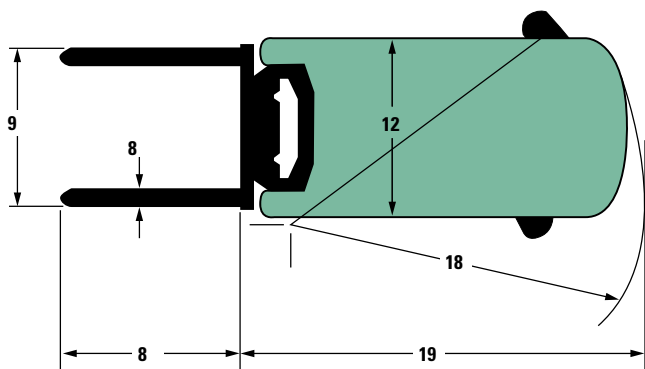
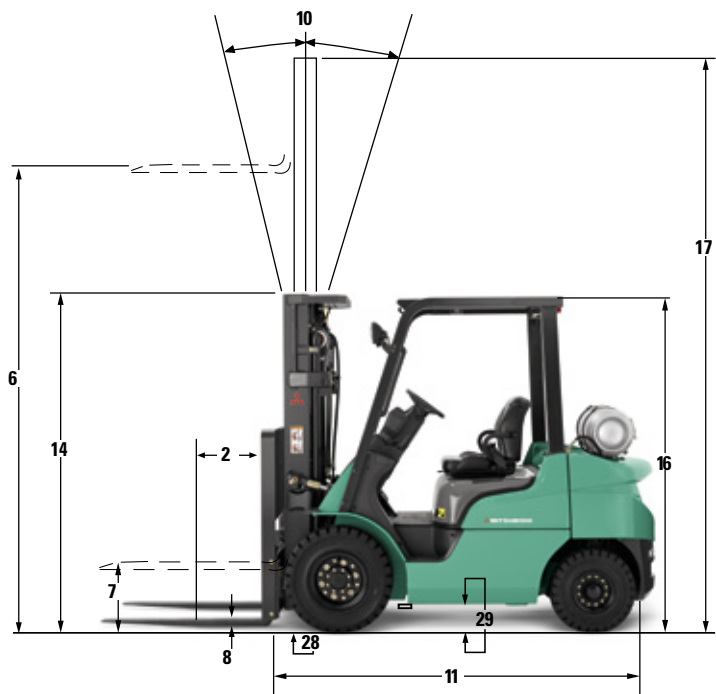



Service with a smile:

500-hour service intervals helps you save on maintenance costs with less downtime for service. One more reason to smile.

Winning warranties:

We've got you covered with parts and labor for all systems for one year and an additional year for all powertrain components. Just 365 more reasons to relax.



Plenty of parts:

From genuine Mitsubishi forklift truck parts to Promatch® parts for any forklift model, we're your single source.

We Stand Behind Our Products

The FG25N and the rest of the Mitsubishi Forklift Truck line-up are backed by some of the industry's best services. Our programs – just like our forklifts – deliver great value.

3,000-7,000 lb Capacity Pneumatic Tire Forklift Trucks



Ready. Reliable. Right On The Money.

Manufactured with superior quality and exceptional value, Mitsubishi forklift trucks are supported by an extensive dealer and field support network, located throughout North and South America.

Don't forget to ask your local dealer about details on:

- Factory retail programs
- Financing plans to meet your individual needs
- Additional options and dealer services

1-888-mit-lift • www.mit-lift.com



Mixed Sources

Product group from well-managed
forests, controlled sources and
recycled wood or fiber
www.fsc.org Cert no. SW-COC
© 1996 Forest Stewardship Council

Copyright © 2010 by MCFA. All rights reserved. All registered
trademarks are the property of their respective owners.
Some products may be shown with optional equipment.
Printed in U.S.A.



MITSUBISHI
FORKLIFT TRUCKS